

Amitabha Village Retreat Center Development

Great Buddha / Meditation Hall, Teachers' Quarters, and Grounds



BACKGROUND

Lansing Buddhist Association (LBA) is a non-profit organization devoted to the practice and teaching of Buddhism. We have had the pleasure of serving the greater Lansing community since 1995. Our practice emphasizes the Ch'an and Pureland traditions, but we also learn eagerly from other Schools of Buddhism. Inspired by the boundless joy and compassion of the great Buddhist masters, LBA seeks to bring loving kindness, healing, and compassion to our neighbors and the world.

In the past 10 years, LBA has actively spread the Buddhist teachings in our community. We organized many successful large retreats and events in English and Chinese. Numerous Dharma teachers from as far away as Taiwan, Malaysia, and Tibet have been invited for short visits to give talks and guide meditation practice. *LBA has also created a thriving multiethnic Buddhist community and proudly brought together Chinese, Americans, Vietnamese, and South Asians to study and practice Buddhism in English.* Currently, LBA is hosting Venerable Chan Yuan, who leads our Pureland practice in Chinese, including monthly Great Compassion Repentance, Pureland Retreats, as well as our three-day Thanksgiving Pureland Retreat.

With the successful expansion of its activities, LBA has now outgrown its original meeting hall. Since we lack a well-equipped building, we have to rely on the facilities of our kind neighbor—Dhammasala Forest Monastery. Consequently, we feel it is time for LBA to build a peaceful and serene environment of its own so that we will be able to hold larger activities and provide more living quarters for our Dharma teachers. *To build the Amitabha Village Retreat Center Building Project is our wonderful and sublime vow.* The project includes building a Great Dharma Hall for meetings and retreats, and providing living quarters for teachers. Once built, the project will harmonize with its beautiful surrounding rural setting. We would like to invite you to join us in this great course and help us to plant and nurture the growing seeds of Dharma in our community.

In the past, many generous hearts have supported us with universal compassion, joy, and unselfish giving. Now with the Amitabha Village Retreat Center Building Project, your continuing contribution plays an even more important role in the spread of Buddha Dharma. *Your donation will bring us closer to the completion of the Project and also help bring more people closer to enjoying the teachings of the Buddha.*

In order to provide you with information on the importance of your generosity in helping us achieve the goal, we have detailed in the following the Vision of Amitabha Village Retreat Center Project for your review.

THE VISION OF AMITABHA VILLAGE RETREAT CENTER

Buddhism teaches us to calm the mind so that we may live with happiness and harmony in this restless world. By providing ample space for activities, residence for teachers, and beautiful landscaping, the building project will help realize the full vision of the Amitabha Village Retreat Center: a place that inspires inner growth and provides a peaceful, comfortable environment for Buddhist practice. The center will serve the community by

- Encouraging the study and practice of Pureland and Ch'an Buddhism
- Providing Pureland and Ch'an retreats
- Providing a book and audio/visual library on Buddhism
- Inviting guest speakers for Buddha-Dharma practices
- Arranging family-style Buddhism-related activities
- Producing Pureland and Ch'an activities in Chinese and English
- Hosting retreats and teachings from other Buddhist schools, and encouraging philanthropy

Weekly group chanting, sutra study, Ch'an meditation, monthly Pureland Retreats, beginner meditation classes, family-style Buddhist activities including Buddhist education for children, seven day retreats, Dharma talks and seminars are among the many activities that can take place at the Center once the project is completed.

BUILDING PROJECT PROGRESS AND SCHEDULE

Thanks to the encouragement of the Venerable Chi Chern and other Dharma Masters, as well as the participation and contribution of the public, the Amitabha Village Retreat Center building project has already been initiated. A building committee has done extensive planning. Detailed building plans have been drawn up, arrangements with builders and engineers have been completed, and more than \$130,000 has already been raised and more money has been pledged.

Presently, we are in the process of obtaining the Special Use Permit from local authorities required to begin construction. We hope to start construction in the fourth quarter of 2005, complete the external structure of the great meditation hall by the end of 2005, and obtain the required occupancy permit as soon as funding is available.

GREAT BUDDHA / MEDITATION HALL

Durable, Low Maintenance and Cost Effective Design:
The building will be of commercial quality post-frame structure in a beautiful setting.

Flexible Floor Plan (provides space for 60 people):
3500 sq-ft space with 10 ft all around porch (about 2700 sq-ft) including 1750 sq-ft auditorium, 750 sq-ft reception / meeting / library area, 450 sq-ft open corridor / shelf / closets, 400 sq-ft bathrooms & showers, and a consultation suite.

Floor Plan

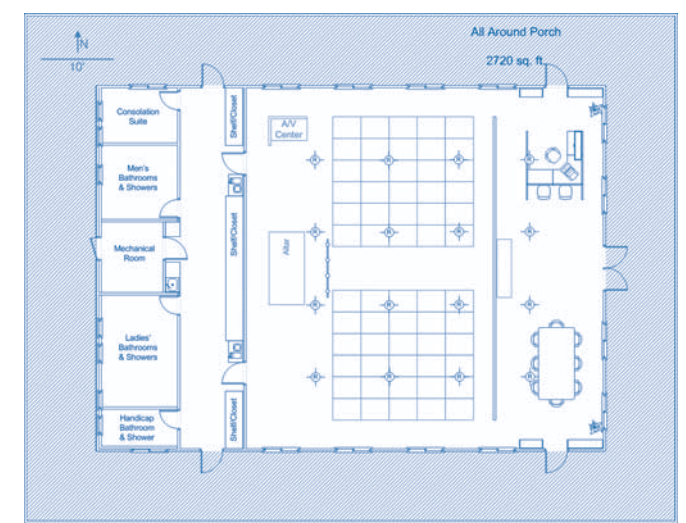

East Elevation



COST

- Land: \$70,000 - Already pledged by several board members
- Construction: \$190,000 to start construction
- \$120,000 additional funding to complete the Great Buddha/Meditation Hall
- \$50,000 budget to build Teachers' Quarters

FUNDRAISING PLAN

We hope to raise One Hundred Dollars from One Thousand People. We ask you to make a \$100 donation. However, donations of any amount are welcome and deeply appreciated. Your participation and contribution will enable the timely completion of the project, and more importantly, allow the community to share the benefits of the Buddha Dharma. A plaque will be placed on the AVRC as a sign of appreciation, and to give special thanks to our big donors.

- Honored Members:
\$1,000 Contribution (A dollar a day for 3 years)
- Honored Board Members:
\$5,000 Contribution (Five dollars a day for 3 years)
- Amitabha Village Sponsors:
\$5,000 or more (10-year interest-free loan)

LBA will provide you with ongoing detailed financial reports as well as progress reports of the AVRC building project. We sincerely appreciate your support, and wish that you be blessed by the growth of happiness and wisdom. May Dharma Joy be with you.

CONTRIBUTIONS

Please make checks payable to: Lansing Buddhist Association

Mail to: LBA c/o Ms. Shu-Jen Hsieh
1315 Farwood Dr.
East Lansing, MI 48823

CONTACT

Phone: Lina Wu & Chungwen Chen 517-351-7077
Lisa & Peter Kong 517-332-0003
Nancy & James Jean 517-349-6441
Shu-Jen Hsieh 517-337-8973

Website: www.geocities.com/lansingbuddhist

Thank you. Your support is deeply appreciated.

Brochure Design: www.bluewavestudios.com

Lansing Buddhist Association
1315 Farwood Drive
East Lansing, MI 48823



Amitabha Village Retreat Center Development

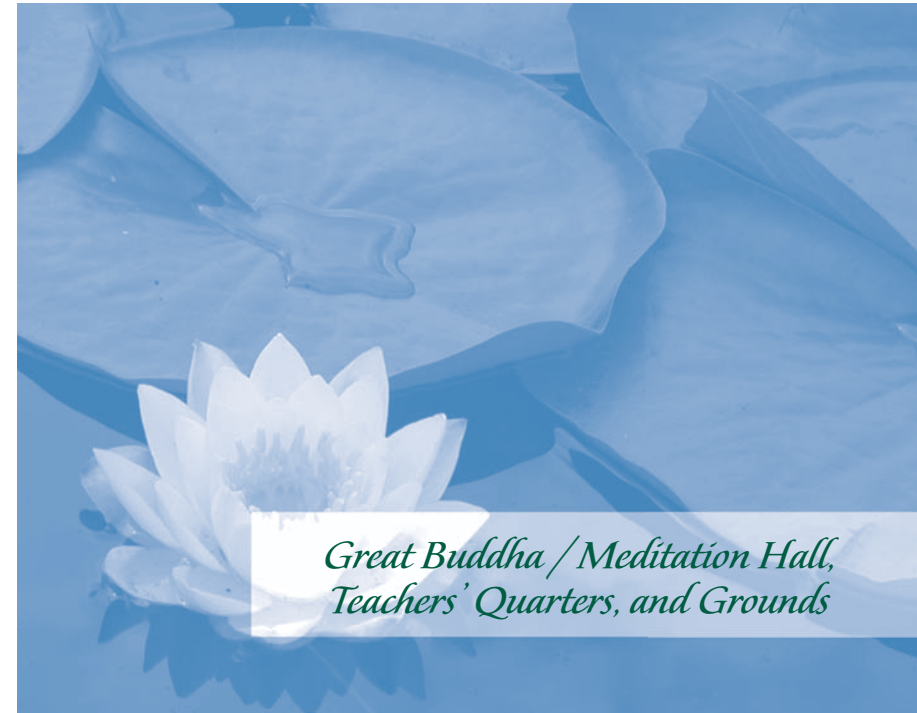

*Great Buddha / Meditation Hall,
Teachers' Quarters, and Grounds*



Lansing Buddhist Association